



# Product Specification

LED5



---

## INTRODUCTION

---

The LED5 incorporates lithium batteries for extended warranty and lifetime. Designed to complement mains operated luminaires, the LED5 is a standalone non maintained emergency luminaire and is available in standard, self test and autotest emergency variants. Lens options include open area, escape route and spot lenses ensuring that the LED5 can be used in most emergency applications, whilst a one piece lens and bezel design ensures that the LED5 offers an IP65 rating to the ceiling surface when installed with appropriate sealant.

**UK  
CA** CE IP65

---

## APPLICATION

---

- Canteen
- Commercial / Offices
- Corridor
- Education
- Food Production
- Healthcare / Social Housing
- Hotel / Leisure
- Industrial / Manufacturing
- Kitchen
- Office
- Retail
- Stairwell
- Store Room
- Toilet
- Transport
- Warehousing

---

## SPECIFICATION

---

### CONSTRUCTION

- Housing: Injection moulded polycarbonate
- Finish: Matt white
- Lens: Injection moulded PMMA lens
- IP65

### ENVIRONMENTAL

- Designed to allow simple replacement of components with commonly available tools in compliance with the Eco Design Directive, please see the installation leaflet for maintenance instructions.
- Every luminaire is labelled with a unique ID number allowing easy identification of spare parts for the lifetime of the product.
- UK based manufacturing providing local support throughout the product lifetime and minimising transportation miles.

### EMERGENCY

- Available with optional standard, self test and autotest integral emergency with lithium batteries for extended warranty and lifetime.

### INSTALLATION

- Suitable for plasterboard installation
- Suitable for mineral fibre ceiling tile installation

### VARIATIONS

- Available in white or black finishes

---

## IMAGES

---

PRODUCT IMAGES



**TECHNICAL**

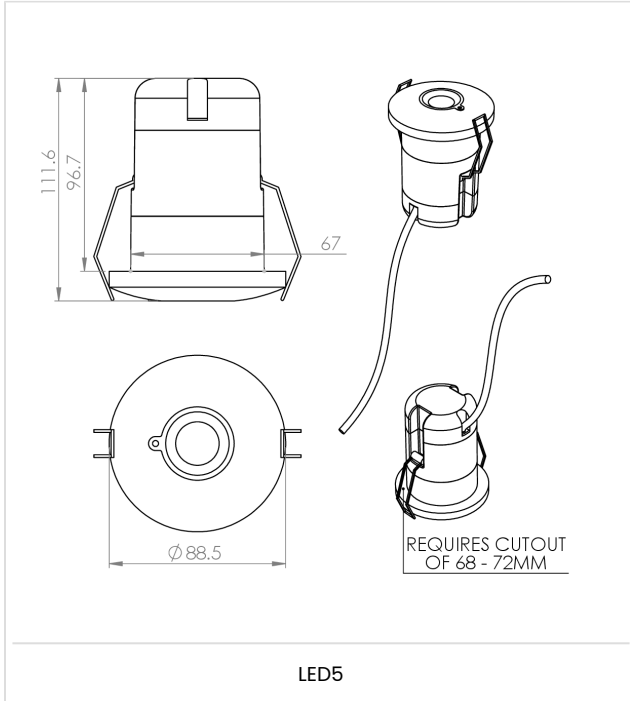

---

## WARRANTY

---

At Dextra our commitment to service has been at the forefront throughout our history spanning more than forty years in the UK lighting market. Our service ethos extends beyond design and delivery, we believe supporting your installation throughout the warranty period is equally crucial, whilst the strength and longevity of Dextra Group provides peace of mind that our warranty will be supported throughout.

The Dextra range is supplied with a five year warranty commencing from the date of delivery. During the first three years defects will be repaired on site and the warranty will include both parts and labour. For the final two years drivers, emergency modules, wireless modules, sensors and LED circuits will be supplied free of charge to replace defective components, labour and other associated costs are not included.

Certain ranges and components are subject to exemptions:

- ▶ Lithium batteries are provided with a five year warranty. During the first three years defects will be repaired on site and the warranty will include both parts and labour. For the final two years replacement batteries will be supplied free of charge to replace defective components. Five year warranty became effective as of 03/02/25, Lithium emergency luminaires supplied prior to this date are supported with a three year on site warranty only. Labour and other associated costs are not included. Nickel Metal Hydride and Nickel Cadmium batteries are provided with a one year warranty for parts and labour.
- ▶ Emergency luminaires including AME2, EXI LED, EXI3, HBE3, HBE4, OAT2 LED and Twinspace are supplied with a one year warranty for parts and labour. Lithium variants suffixed with the 5YR part code, the Autotest emergency with the LA3 part code and wireless variants with LA3RC or LSTR part codes are supplied with a five year warranty. For these extended warranty variants for the first three years defects will be repaired on site and the warranty will include both parts and labour. For the final two years replacement batteries will be supplied free of charge to replace defective components.
- ▶ Protec Micro, PTECF7 Fire Rated Downlights, Serenus and the Opus Sconce are provided with a five year replacement luminaire only warranty. Protec FR Fire Rated Downlights are provided with a 2 year replacement luminaire only warranty.
- ▶ Controls systems such as standalone sensors, switches, marshalling boxes and cabling are provided with a one year warranty for both parts and labour. DALI control systems are provided with a two year warranty for both parts and labour.
- ▶ LEDextra ranges are supplied with a three year parts or replacement luminaire only warranty with the exception of the IMPR RGBW, the Runway RGBW, the MOD RGBW, Tanek RGBW and the DexRing. These five ranges are supplied with our standard five year warranty during which defects within the first three years will be repaired on site and the warranty includes both parts and labour. For the final two years free of charge replacement components only will be supplied to rectify any failures but labour and other associated costs are not included.
- ▶ LEDEX ranges are supplied with a three year replacement luminaire only warranty.
- ▶ The Decorative Pendant ranges, Bebo, Dene, Nova, Fino and Stix are supplied with a 3 year replacement luminaire only warranty.

All warranties are subject to correct use of the product and will be invalidated by misuse, for example incorrect installation, unsuitable environmental conditions or incorrect maintenance. It is the duty of the customer to ensure that all the fault lies with the luminaire prior to requesting replacement parts or site repairs. In the event that no defect is found with the product our costs for attending site will be recharged to the customer and credit

will not be issued against returned products. No consequential losses incurred resulting from any defect with our product will be reimbursed.

Given the nature of LED technology a small percentage of LEDs may fail during the lifetime of a luminaire, this does not cause a reduction in lumen output. As such LED luminaires are only deemed to be faulty for warranty purposes when in excess of ten percent of LEDs have failed in a single luminaire.

On site repair of products under warranty will be undertaken during normal working hours, 9am to 5pm Monday to Friday, and will require unrestricted access to luminaires. Where required Dextra will provide access equipment to carry out repairs at height, should luminaires have been installed in locations where reasonable provision for maintenance access has not been made we reserve the right to supply replacement product only. On site warranty repairs will only be undertaken on the mainland of the UK and Ireland, in all other locations replacement product only will be provided.

**If you require any assistance with regards to our products please contact our Customer Services department on 01747 858100.**

---

**ORDER CODES**

---

**LUMINAIRE**

Code	Description	Power
LED5RE NM3 LE3	LED5, 367lm, Escape, Lithium Non-Maintained, Standard Emergency 3 Hour	2.0W
LED5RE NM3 LS3	LED5, 367lm, Escape, Lithium Non-Maintained, Self Test Emergency 3 Hour	2.0W
LED5RE NM3 LA3	LED5, 367lm, Escape, Lithium Non-Maintained, Auto Test Emergency 3 Hour	2.0W
LED5RO NM3 LE3	LED5, 367lm, Open Area, Lithium Non-Maintained, Standard Emergency 3 Hour	2.0W
LED5RO NM3 LS3	LED5, 367lm, Open Area, Lithium Non-Maintained, Self Test Emergency 3 Hour	2.0W
LED5RO NM3 LA3	LED5, 367lm, Open Area, Lithium Non-Maintained, Auto Test Emergency 3 Hour	2.0W
LED5RS NM3 LE3	LED5, 367lm, Spot, Lithium Non-Maintained, Standard Emergency 3 Hour	2.0W
LED5RS NM3 LS3	LED5, 367lm, Spot, Lithium Non-Maintained, Self Test Emergency 3 Hour	2.0W
LED5RS NM3 LA3	LED5, 367lm, Spot, Lithium Non-Maintained, Auto Test Emergency 3 Hour	2.0W

Lumen outputs based on Open Area lens

All products are supplied with a 5 year battery warranty

220-240V / 50-60Hz  
IP65 IK03

**Terminal Labelling:**

**Power**  
N Neutral

**Emergency**

L2 Unswitched Live  
DA/AT3 DALI Autotest  
DA/AT3 DALI Autotest



**WARNING:** Luminaire must be earthed. Risk of electric shock from LED boards if operated with cover removed. Installation / operation outside of luminaires intended scope invalidates warranty. Suitable only for domestic / light industrial / industrial applications within the scope of EN55015. Tested to compliance with BSEN 60598: specification for general requirements and tests. Must be installed by a suitably qualified person in accordance with all relevant legislation. Ambient operating temperature of 0°C to 25°C. If maximum operating temperature is exceeded luminaire will automatically dim / switch off. Terminal blocks are rated to 16A unless stated otherwise. The light source contained in this luminaire shall only be replaced by the manufacturer or his service agent or a similar qualified person. **LUMINAIRES WITH EMERGENCY PACK:** When supply is isolated battery output terminals may be live if battery is connected. Isolate mains and battery before servicing. Emergency luminaires require unswitched live connection taken from same phase as switched supply. When unswitched supply is connected status indicator illuminates green, when unswitched supply is disconnected indicator extinguishes and luminaire operates in emergency mode. 24 hour charge period required before undertaking full discharge test. Emergency test sheets provided should be used to record all emergency tests. Batteries should be replaced when 3 hour duration is not met. Excessive switching of permanent live may result in premature battery failure. Battery electrolyte can be harmful to eyes / open wounds, do not puncture, if electrolyte touches skin / eyes flush with water. Do not incinerate batteries.

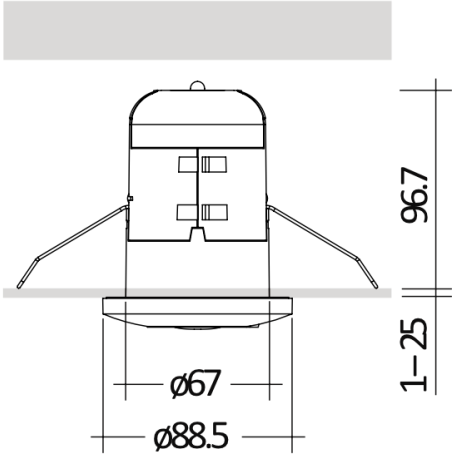
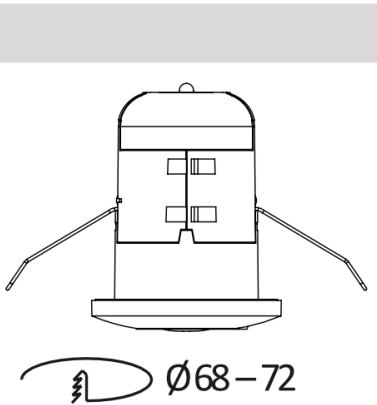

**Escape**

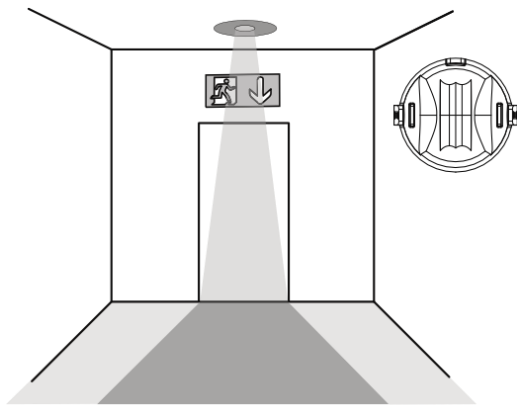

**Anti Panic**

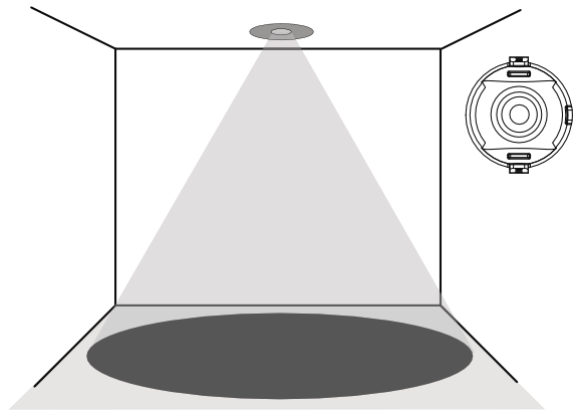

**1.**

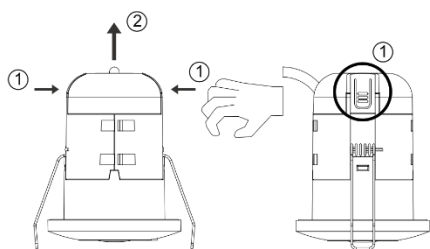

**2.**

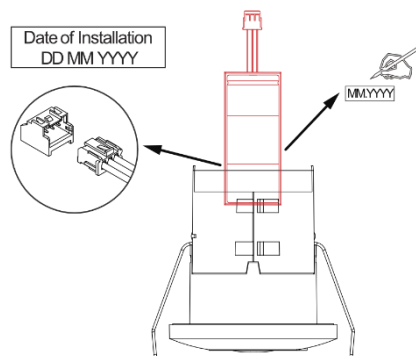

**3.**

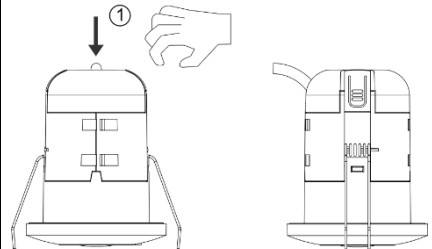

## LED5 Installation Guide

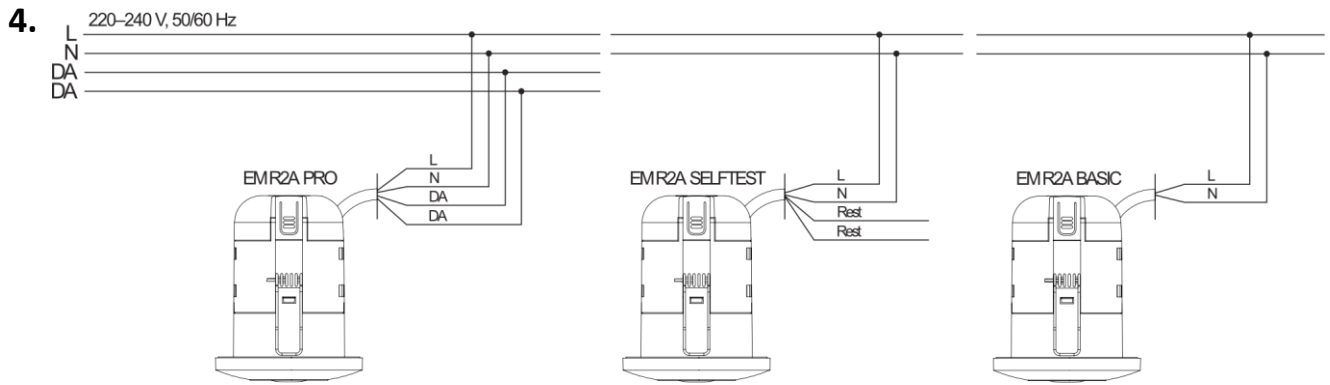

Note: If the mains cable or battery strap are damaged, the luminaire must be disposed of.

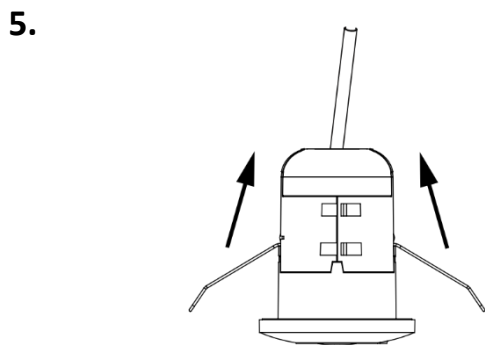

Only a terminal complying with EN 60998-2-1 or EN 60998-2-2 can be used.

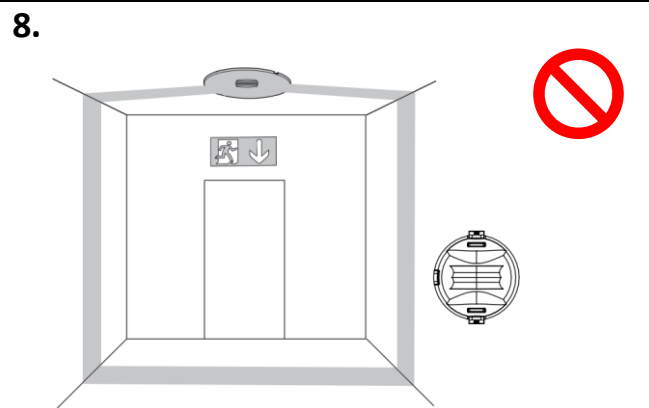
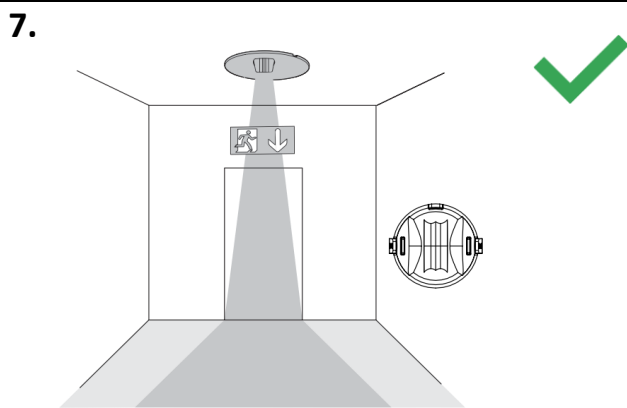
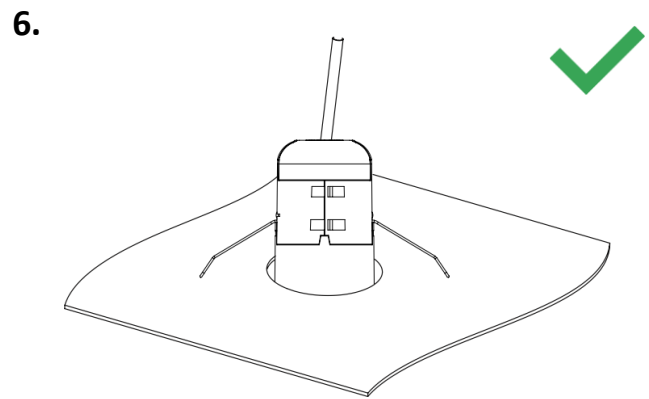

### Battery Replacement

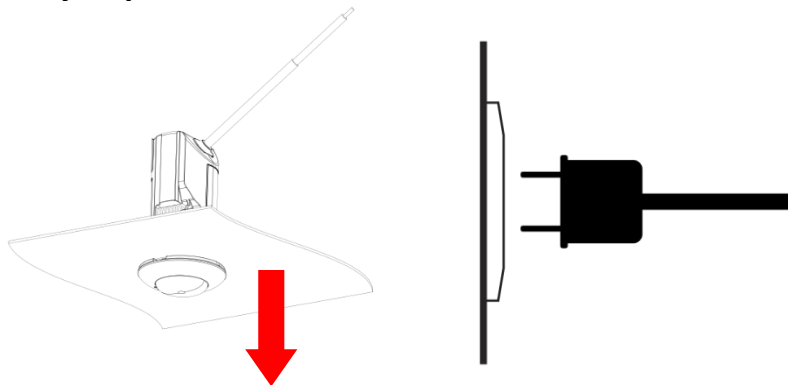

For re-connection of battery, refer to step 1.

After a battery replacement and a subsequent full charge cycle (24h), a duration test is mandatory to prove that with the new battery the rated duration is achieved.