

220-240V / 50-60Hz
IP65 IK10

Terminal Labelling:

Power

L1 Switched Live
E Earth
N Neutral

Emergency

L2 Unswitched Live
DA/AT3 DALI Autotest
DA/AT3 DALI Autotest

Dimming

-/D1/DA Analogue/DSI/DALI
+/D2/DA Analogue/DSI/DALI
L3 Switch Dim / Corridor Funct



WARNING: Luminaire must be earthed. Risk of electric shock from LED boards if operated with cover removed. Installation / operation outside of luminaires intended scope invalidates warranty. Suitable only for domestic / light industrial / industrial applications within the scope of EN55015. Tested to compliance with BSEN 60598: specification for general requirements and tests. Must be installed by a suitably qualified person in accordance with all relevant legislation. Ambient operating temperature of 0°C to 25°C. If maximum operating temperature is exceeded luminaire will automatically dim / switch off. Terminal blocks are rated to 16A unless stated otherwise. The light source contained in this luminaire shall only be replaced by the manufacturer or his service agent or a similar qualified person. **LUMINAIRES WITH EMERGENCY PACK:** When supply is isolated battery output terminals may be live if battery is connected. Isolate mains and battery before servicing. Emergency luminaires require unswitched live connection taken from same phase as switched supply. When unswitched supply is connected status indicator illuminates green, when unswitched supply is disconnected indicator extinguishes and luminaire operates in emergency mode. 24 hour charge period required before undertaking full discharge test. Emergency test sheets provided should be used to record all emergency tests. Batteries should be replaced when 3 hour duration is not met. Excessive switching of permanent live may result in premature battery failure. Battery electrolyte can be harmful to eyes / open wounds, do not puncture, if electrolyte touches skin / eyes flush with water. Do not incinerate batteries.

1.

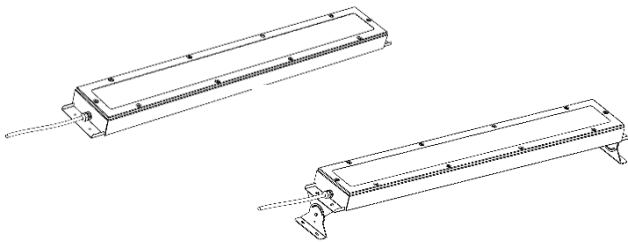

Fitting comes **without** a flex as **standard** but can be ordered pre flexed on request. (If pre flexed skip stages 6-12)

2.

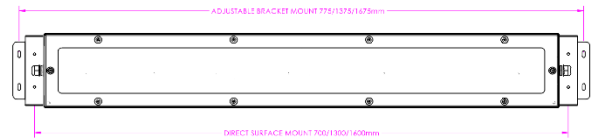

Direct mount or use optional adjustable bracket, fix to the desired mounting surface. (fixing screws to be supplied by installer)

3.

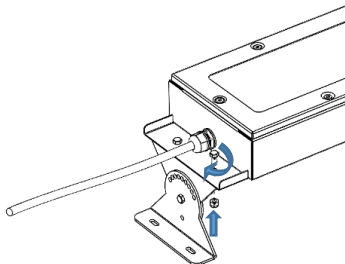

Optional adjustable brackets - Bolt brackets to the luminaire using the supplied fasteners.

4.

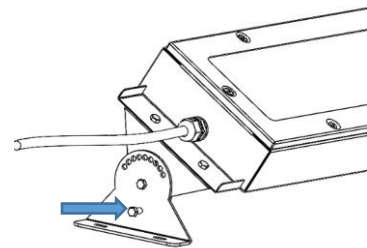

Optional adjustable brackets - Angle can be adjusted in 15 degree increments. (Use supplied locking bolt to secure at desired angle)

5.

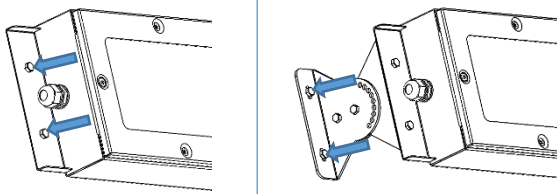

Secure to mounting surface using the required bracketry. (If pre flexed skip stages 6-12)

6.

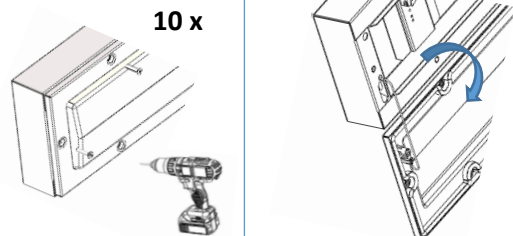

Undo luminaire using the 10 x M5 6 Lobe Pin Drive screws securing the frame. Remove the frame and proceed to hang it on the tethers.

Tanek Glass Rail

7.

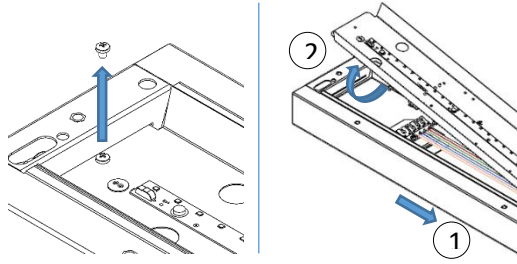

Remove the screw holding the gear tray in place. (1) Push the tray to one side. (2) Lift and tilt the gear tray to remove.

8.

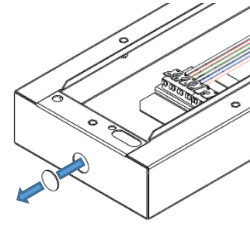

Drill 20mm hole or knockout the semi-shear from the housing if bringing the cable in through the side. **Please note, it is the contractor's responsibility to ensure the holes are suitably sealed. Failure to do so will invalidate the luminaire's IP rating.**

9.

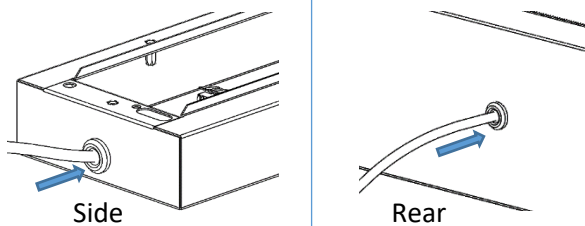

Feed flex through preferred cable entry (**contractor to supply suitable grommet**). Make relevant electrical connection (all fittings will have 6 pole terminals due to generic housing to tray connector loom).

10.

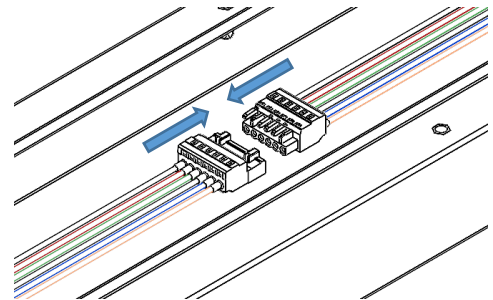

Connect the tray to the housing using the internal loom.

11.

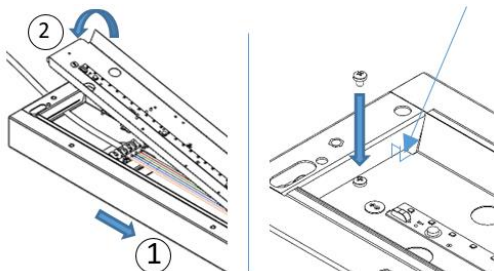

(1) Slide one end of the gear tray into the housing. (2) Lower the gear tray into place. Secure the tray with the tab or screw that was removed earlier in step 2.

12.

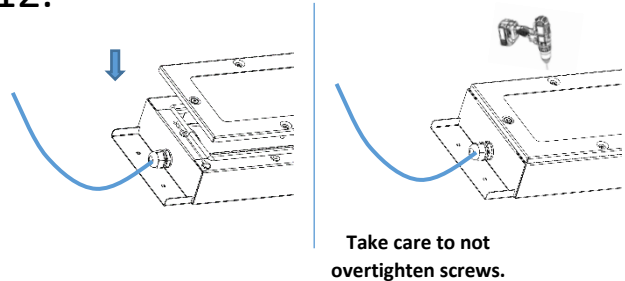

Take care to not overtighten screws. Offer frame up to the housing. Insert all M5 screws before fully tightening to ensure alignment. (Ensure frame tether is connected)

Maintenance

1. Disconnect luminaire before undertaking any maintenance or cleaning.
2. Cleaning should be undertaken on external parts of the luminaire only using a slightly damp lint free cloth.
3. To access fitting remove the M5 Lobe Pin Drive Screws. Frame and diffuser can now be removed.
4. To remove gear tray and components use a pan pozi screwdriver.

5. Please contact Dextra for assistance with spare component supply.

